



# 2750 Fruitland Ave

VERNON, CA 90058

## FOR LEASE



**Kidder  
Mathews**

**TOM HOLLAND, SIOR, CCIM, CPM**

EVP, Shareholder

323.270.8456

[tom.holland@kidder.com](mailto:tom.holland@kidder.com)

LIC N° 01186709

This information supplied herein is from sources we deem reliable. It is provided without any representation, warranty, or guarantee, expressed or implied as to its accuracy. Prospective Buyer or Tenant should conduct an independent investigation and verification of all matters deemed to be material, including, but not limited to, statements of income and expenses. Consult your attorney, accountant, or other professional advisor.

**FOR LEASE**

# 2750 Fruitland Ave

VERNON, CA 90058

## Site Plan

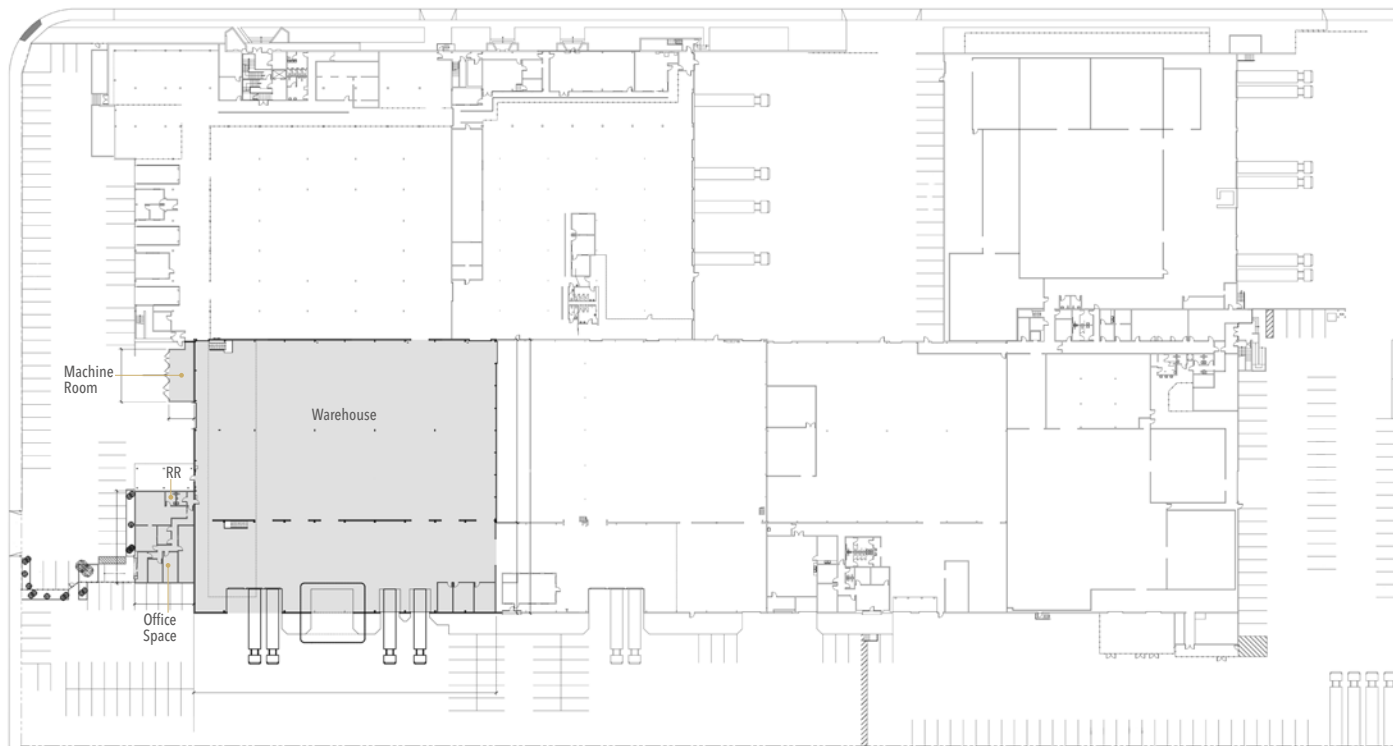

**39,352 SF**

MANUFACTURING /  
WAREHOUSE FACILITY

**2,419 SF**

OFFICE SPACE (TO SUIT)

**36,933 SF**

WAREHOUSE SPACE

**\$0.76**

PER SQUARE FOOT RENT

**\$0.03**

PER SQUARE FOOT CAM

**TOM HOLLAND, SIOR, CCIM, CPM**

EVP, Shareholder

323.270.8456

[tom.holland@kidder.com](mailto:tom.holland@kidder.com)

LIC N° 01186709

**KIDDER.COM**

This information supplied herein is from sources we deem reliable. It is provided without any representation, warranty, or guarantee, expressed or implied as to its accuracy. Prospective Buyer or Tenant should conduct an independent investigation and verification of all matters deemed to be material, including, but not limited to, statements of income and expenses. Consult your attorney, accountant, or other professional advisor.



**FOR LEASE**

# 2750 Fruitland Ave

VERNON, CA 90058

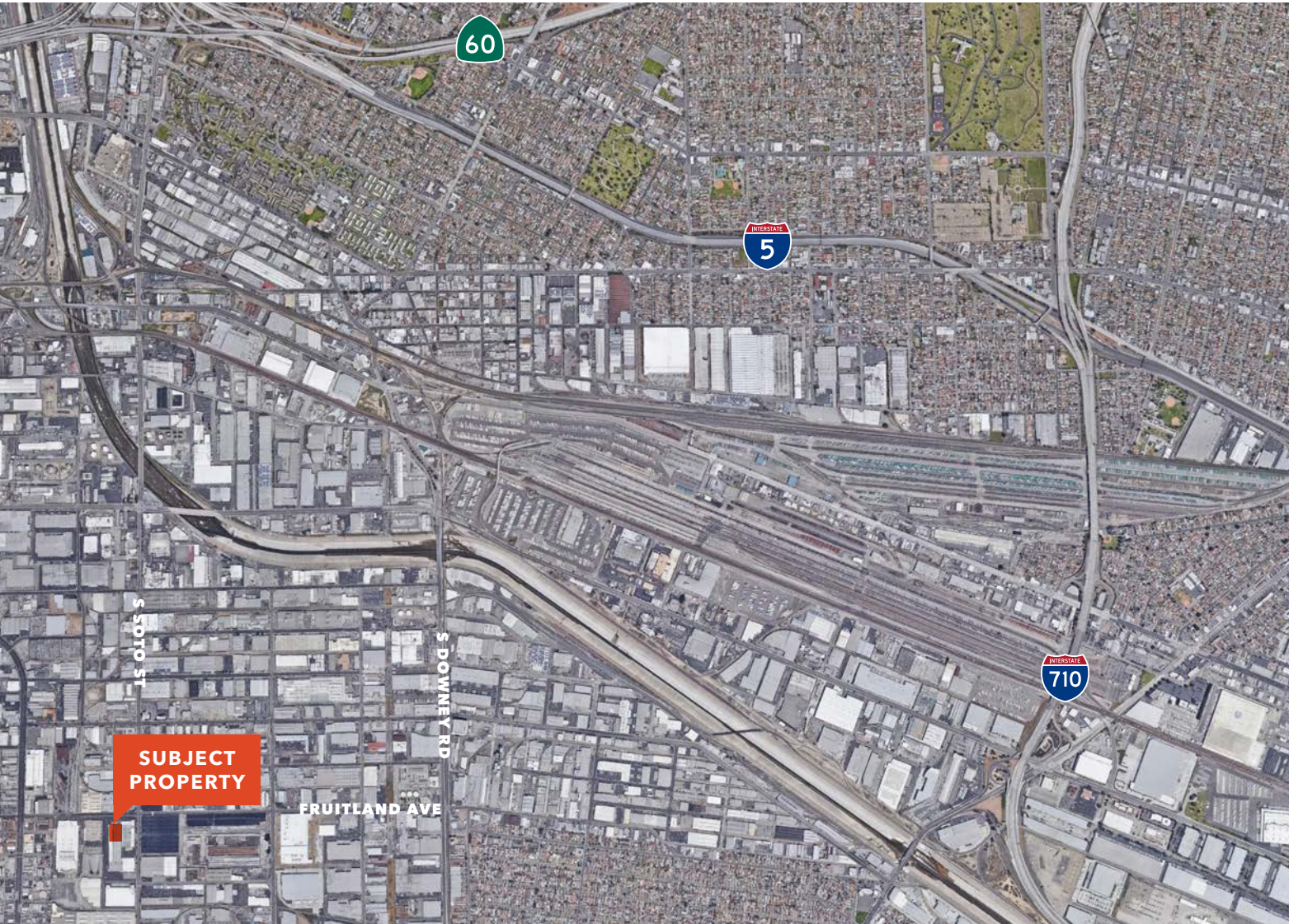

## **BUILDING HIGHLIGHTS**

**2,419 SF** office space

**36,933 SF** warehouse space

**25'** clear height

\*fire sprinklers may only allow tenants to stack up to 17'

**5** dock high doors

**2** ground level doors

**HEAVY** power

**LARGE** truck court

**20** parking spaces

**ASKING RATE** \$0.85 PSF

**\$0.03** PSF CAM

**TOM HOLLAND, SIOR, CCIM, CPM**

EVP, Shareholder

323.270.8456

[tom.holland@kidder.com](mailto:tom.holland@kidder.com)

LIC N° 01186709

**KIDDER.COM**

This information supplied herein is from sources we deem reliable. It is provided without any representation, warranty, or guarantee, expressed or implied as to its accuracy. Prospective Buyer or Tenant should conduct an independent investigation and verification of all matters deemed to be material, including, but not limited to, statements of income and expenses. Consult your attorney, accountant, or other professional advisor.

**km** Kidder Mathews

**FOR LEASE**

# 2750 Fruitland Ave

VERNON, CA 90058

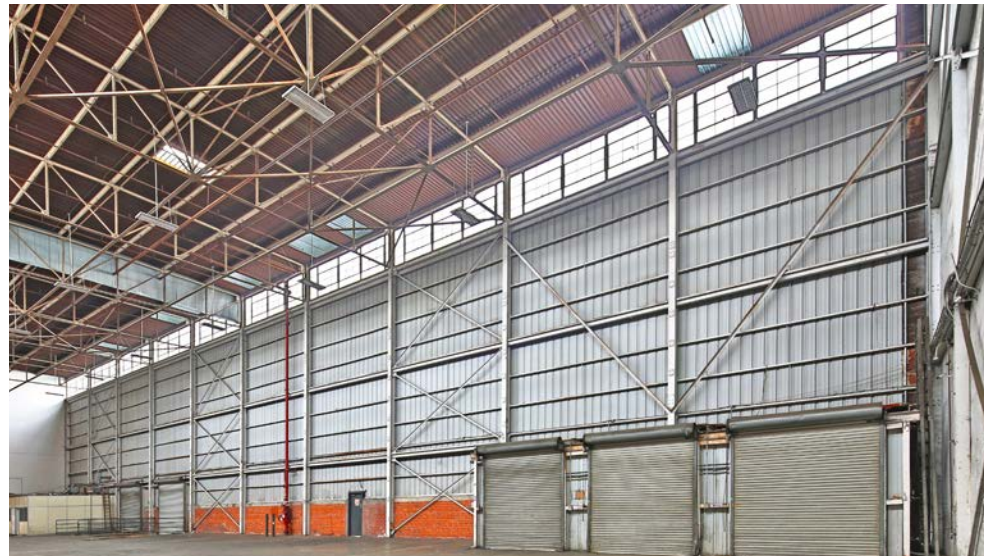

**TOM HOLLAND, SIOR, CCIM, CPM**  
EVP, Shareholder  
323.270.8456  
[tom.holland@kidder.com](mailto:tom.holland@kidder.com)  
LIC N° 01186709

**KIDDER.COM**

This information supplied herein is from sources we deem reliable. It is provided without any representation, warranty, or guarantee, expressed or implied as to its accuracy. Prospective Buyer or Tenant should conduct an independent investigation and verification of all matters deemed to be material, including, but not limited to, statements of income and expenses. Consult your attorney, accountant, or other professional advisor.

**km** Kidder  
Mathews